



Date: _____ Type: _____

Firm Name: _____

Project: _____

PDS-60ca 7.5 V Pre-programmed

Power / data supply for indoor and outdoor applications

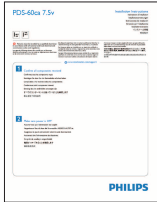

☰ For device mounting and maintenance details, refer to the *Installation Instructions* included in the product packaging, or download documentation from www.philipscolorkinetics.com/lis/pds/pds60ca7/

PDS-60ca 7.5 V Pre-programmed is a versatile power / data supply designed for indoor and outdoor LED lighting fixtures employing Chromasic technology from Philips Color Kinetics.

PDS-60ca 7.5 V Pre-programmed features built-in visual effects, allowing configurations without Ethernet or DMX controllers.

In runs with multiple power / data supplies, PDS-60ca 7.5 V Pre-programmed functions as a master control unit, delivering data to the other power / data supplies in the run. Use one PDS-60ca 7.5 V Pre-programmed unit per run, and standard PDS-60ca 7.5 V DMX / Ethernet units for all additional power / data supplies.

PDS-60ca 7.5 V Pre-programmed delivers 62 watts of power output and automatically

accommodates input voltages ranging from 100 – 240 VAC. Short-circuit protection prevents device failure due to incorrectly wired fixtures.

Featuring a NEMA 4 (IP66) enclosure, PDS-60ca 7.5 V Pre-programmed installs in dry, damp, and wet locations.

PDS-60ca 7.5 V Pre-programmed offers multiple standard-size conduit entries to accommodate 1/2 in (13 mm) and 3/4 in (19 mm) trade-sized conduit.

Compatible Fixtures

Fixture	Max. Quantity Per PDS-60ca 7.5 V
iColor Flex MX	2 strings
iColor Tile MX	1

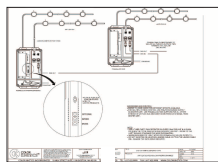

☰ PDS-60ca Pre-programmed wiring diagrams are available online at www.philipscolorkinetics.com/support/wiring/

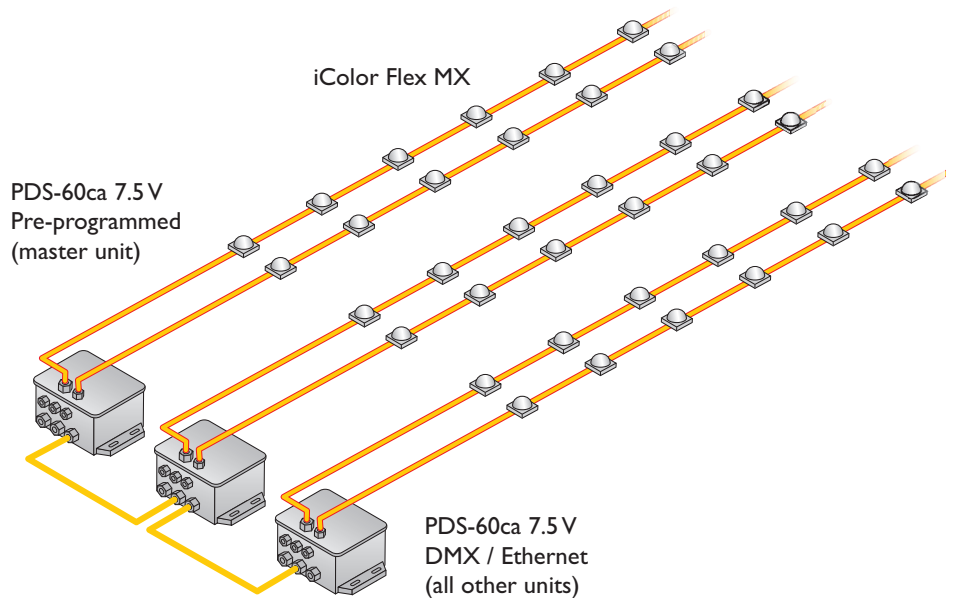

Specifications

Due to continuous improvements and innovations, specifications may change without notice.

Item	Specification	Details	
Electrical	Input Voltage	100 – 240 VAC, auto-switching, 50 / 60 Hz	
	Maximum Input Current	1.7 A at 100 VAC, 1.5 A at 120 VAC, .75 A at 240 VAC	
	Power Output	7.5 VDC, 62 W maximum	
	Fuse Rating	(2) 5 A, 5 x 20 fast blow fuses	
Physical	Dimensions (Height x Width x Depth)	3.6 x 5.5 x 8.8 in (91 x 140 x 224 mm)	
	Weight	4.5 lb (2.0 kg)	
	Construction	Cast aluminum enclosure with slots for surface mounting	
	Finish	Gray matte	
	Connectors	Data	RJ45 output connector
		Power Output	(2) 4-pin output receptacles
		Power Input	Line-neutral-ground cable, flying leads
	Temperature Ranges	14° – 104° F (-10° – 40° C) Operating 14° – 122° F (-10° – 50° C) Startup -40° – 176° F (-40° – 80° C) Storage	
	Humidity	0 – 95%, non-condensing	
	Cooling	Convection	
	Heat Dissipation	25% of total power input at maximum load	
Data Input Source	Internal		
Certification and Safety	Certification	UL / cUL, PSE	
	Classification	UL Class 2 power supply	
	Environment	Dry / Damp / Wet Location, IP66	

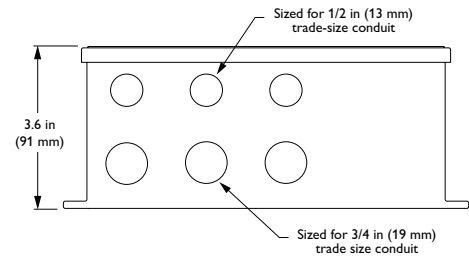
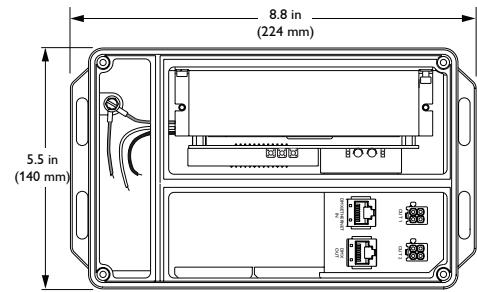

Overall Dimensions

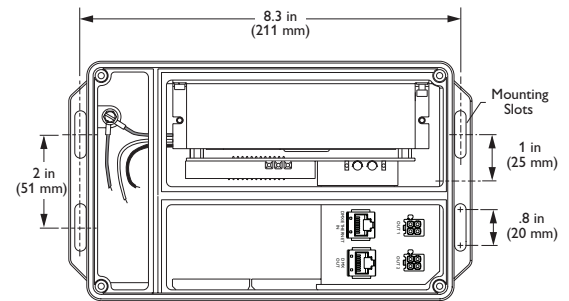

Mounting Dimensions

Ordering Information

Item	Included Components	Item Number	Philips 12NC
PDS-60ca 7.5 V Pre-programmed	Power / data supply, (3) EMI suppression cores, (2) spare fuses, (8) NPT threaded seal plugs, and Installation Instructions	109-000015-00	910503700093

Use Item Number when ordering in North America.

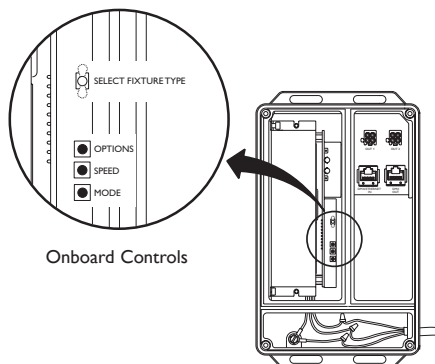

Onboard Controls

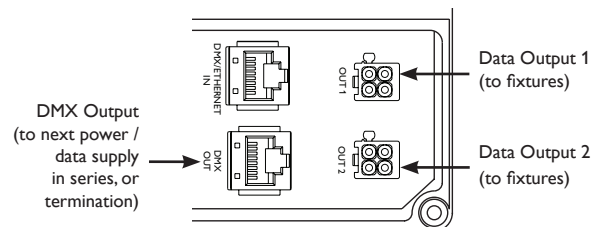

For complete instructions on setting pre-programmed effects via onboard controls, refer to the *Addressing and Configuration Guide* available online at www.philipscolorkinetics.com/support/addressing/



Philips Color Kinetics
3 Burlington Woods Drive
Burlington, Massachusetts 01803 USA
Tel 888.385.5742
Tel 617.423.9999
Fax 617.423.9998
www.philipscolorkinetics.com

Copyright © 2009 – 2012 Philips Solid-State Lighting Solutions, Inc. All rights reserved. Chromacore, Chromasic, CK, the CK logo, Color Kinetics, the Color Kinetics logo, ColorBlast, ColorBlaze, ColorBurst, eW Fuse, ColorGraze, ColorPlay, ColorReach, iW Reach, eW Reach, DIMand, EssentialWhite, eW, iColor, iColor Cove, IntelliWhite, iW, iPlayer, Optibin, and Powercore are either registered trademarks or trademarks of Philips Solid-State Lighting Solutions, Inc. in the United States and / or other countries. All other brand or product names are trademarks or registered trademarks of their respective owners. Due to continuous improvements and innovations, specifications may change without notice. DAS-000060-02 R02 04-12