

Arcblaze 150

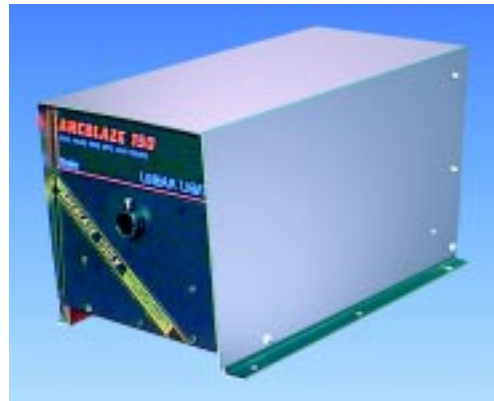

"The highest performing and most versatile 150W metal halide lightsource ever".

Precision engineering, robust stainless steel and machined alloy construction, superb reflector and critical optical path design contribute to making this the flagship of the range. Every Arcblaze shipped to the user is individually configured by the selection of optical sub assemblies, to optimise light transmission into the fibre bundle that is to be actually used, whether that be a small bundle of sidelight cables, solid core cables, glass fibre or a large 40mm bundle of star ceiling fibres. No more "one design suits all" solution. Couple this with the extensive range of available options, and you end up with a lightsource suited to just about any fibre optic application, sidelight or endlight, however demanding.



Typical Applications

- Side lighting
- End lighting
- Sequenced and Segmented Harness
- Electronic synchronisation
- Microstepping DMX, Dual wheel and dimming
- Large bundle size for star ceilings

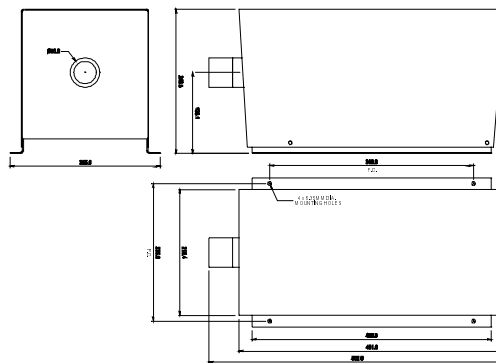

ARCBLAZE 150

- Types: 150 LX for sidelight and endlight bundles up to 17mm dia. (400 fibres 0.75mm)
150H for endlight bundles up to 40mm dia.
150LXDMX / 150HDMX includes DMX control.
- Construction: 304 grade stainless steel and aluminium construction.
- Lamp: 150 W metal halide. G12 base.
Colour temperature 4000 degree Kelvin (3000 degree optional).
6000 hours typical.
Horizontal or base down burning position.
- Reflector: Vacuum deposited, high reflectivity, optical coating on a precision aluminium body, with large collection angle to maximise efficiency.
- Ventilation: 80 CFM, fan forced.
- Environment: Dry location. Operating temperature 0°C - 45°C ambient.
- Filters: UV and Infra-red.
- Optical: Typically 2500 lumens coupled into 25mm diameter bundle.
- Electrical: 240 V @ 2A 50 Hz.
- Protection: Internal thermal cut-out switch. Self resetting.
- Dimensions: 245 H x 215 W x 455 L.
- Weight: 12 kgs.
- Colour Wheel: 6 colour dichroic filter standard.
Yellow, white, magenta, orange, green, blue. (Other colours available).
1 RPM synchronous motor/gearbox (Other speeds available)
- Options: Rear panel motor switch or remote control.
Electronic synchronisation of multiple lightsources.
Dimming. Electro-mechanical and servo systems available.
Shutter. Electro-mechanical high speed shutter option.
- DMX 512: Controls up to two colour wheels (colour mixing), dimming, and lamp switching, temperature monitoring.
Microstepping and standard versions available.

Provisional Data Sheet
23/1/01

Digilin Pty Ltd
A.C.N. 078 278 449
37 Oxford Street
Bulimba
Qld 4171

Ph 61 7 3899 1267 Fax 61 7 3899 1261

For more information please contact

lightmoves (03) 9701 2500
info@lightmoves.com.au

138-146 Browns Rd, Noble Park VIC 3174

Fibre Optic Lighting Technologies

F
I
B
R
E

O
P
T
I
C

L
I
G
H
T
I
N
G