



Philips Dynalite User Interfaces

The ultimate in user interface solutions
– balancing aesthetics and function

PHILIPS
dynalite 

Contents

■ Revolution panels	4-5
■ Classic panels	6-7
■ Standard panels	8-9
■ Custom panels	10-11
■ Touchscreens	12-13
■ iPad and iPhone apps	14-15
■ Sensors	16-17
■ Product ordering Information	18-21

Philips Dynalite user interfaces are available in a range of styles and finishes to match any project budget or décor requirements. The range includes wall panels, touchscreens, universal sensors, timer clocks, temperature sensors and downloadable apps.



The Revolution Series features smooth action back-lit buttons with ultimate functionality and a choice of stunning finishes.



Revolution Series

The ultimate in choice and flexibility. Select from a vast range of standard plate finishes or custom finishes including glass, stone, wood, metal and ceramic. Each button can be custom engraved with text or icons that help describe its functionality and the engraving is back-lit. An option of an integrated OLED display allows fully editable text and icons to indicate the current system status.

North American / Australasian style



DR2PA-KRX-X-W-SG-P-BO-S



DR2PA-JXX-X-C-BG-P-BW-S



DR2PA-AXX-X-W-SG-R-BO-C



DR2P-GXX-X-C-SS-R-BO-C



DR2PA-EXX-X-C-AB-R-BW-C



DR2PA-LQX-X-C-SS-P-BW-S



DR2PA-LQX-X-C-AB-P-BW-S



Range of sizes

Available in the two popular international mounting formats, in single and multi-gang configurations.

Button sizes

Single, double and triple width buttons enhance configuration possibilities.

Two Button heights.

Readily accommodates different facia material thickness, allowing for flexibility in architectural design.

Custom features

Vast range of optional devices including faders, displays, key switches and plug sockets for unique control solutions.

Facia options

Suitable for an extensive range of materials providing unlimited décor matching possibilities.

Led indicators

Available in a range of colours enabling clear indication of system status.

Back-lit buttons

Improves panel visibility in all lighting conditions.

Button engraving

Clearly designates buttons functions ensuring intuitive system operation.

DR2PE-GJR-X-C-SG-P-BW-S

European / Asian style



DR2PE-QXX-X-C-SS-P-BW-S

OLED display allows fully editable text and icons.



DR2PE-JXX-X-C-SS-R-BO-C



DR2PE-AXX-X-W-SG-R-BO-C



DR2PE-GXX-X-C-SS-R-BW-C



DR2PE-EXX-X-C-AB-R-BW-C



DR2PE-AXX-X-C-BG-R-BO-C



DR2PE-LQX-X-S-SG-P-BO-S

Custom facia engraving options.

Custom panels can be created for any commercial or residential use and engraved to your specific requirements.



Classic Series

Contemporarily styled stainless steel panels that are perfectly suited to any commercial environment. Available in a wide range of standard options which include network sockets, key switches and fader sliders. Each plate and switch cap can be custom engraved. Standard options including various button configurations are available throughout the range.

North American / Australasian style



DPN981-SS



DPN914-SF



DPN963-SF



DPN941-SF



DPN921-SF



DPN981-SS



DPN9121-SF

LED indicators provide tactile and visual feedback.

Square button silver caps with black bezel and black engraving. (Charcoal buttons also a standard option.)

High quality brushed **stainless steel** finish.

Caps are easily removed for **engraving** for easy function identification.

Robust panels are perfect for commercial and residential applications.

Custom features Optional devices including faders, displays, key switches and plug sockets for unique control solutions.

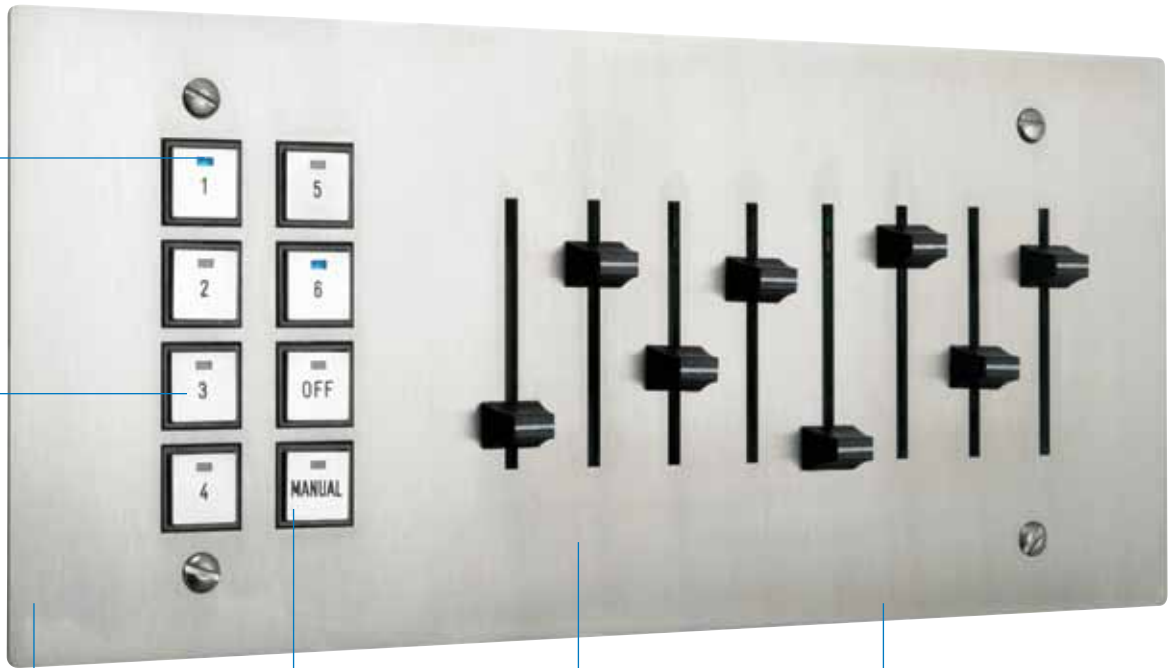

European / Asian style



DPNE921-SF-SS



DPNE941-SF-SS



DPNE963-SF-SS



DPNE9103-SF



DPNE981DN

Custom facia engraving options.



Standard Series

Anything but standard, beautifully formed, highly functional and cost effective. Built with the full Philips Dynalite feature set, these simple yet elegant panels bring the full power of the automated system to a touch of a button. Available in a range of different cover finishes* and switch cap colours.

*Details of finishing options are series dependant.



North American / Australasian style



DLP910



DLP920



DLP950



DLP960



DLP970

European / Asian style



DLPE910



DLPE920



DLPE950



DLPE960



DLPE970

Aesthetically pleasing, and cost-effective method of providing **integrated automation** in commercial buildings and homes.

Available in **two configurations**: single column, up to five buttons and a dual column design for up to ten buttons.

Incorporates a miniature **DyNet control network** socket under the snap-on panel cover, enabling system adjustments and programming from any user control panel on the network.



DLP9100 (actual size)

Available in two profile sizes, the DL2P is **ultra thin**.

Smooth action buttons with **LED** indicators provide tactile and visual feedback and are easily removed for engraving.

Infra-red (IR) receive capabilities have been integrated, eliminating the need for separate sensors where IR remotes are required.



DL2P

DLP

Ultra thin slim line option.



DLPE

DPWE



DLPE9100 (actual size)

Standard options

(throughout range)

- Slim line mounting
- 2 grid plates available, 1 or 2 columns (5 or 10 buttons)
- Smooth action switches with LED indicator
- Optional engraved buttons
- Optional inbuilt infra-red receiver



Custom Panels

Build a custom panel to meet your needs; choose from a multitude of button sizes, colours and layouts; key switches to lock out unauthorised use, mechanical faders for individual channel control and network sockets for connection to the Philips Dynalite DyNet lighting control and home automation network.

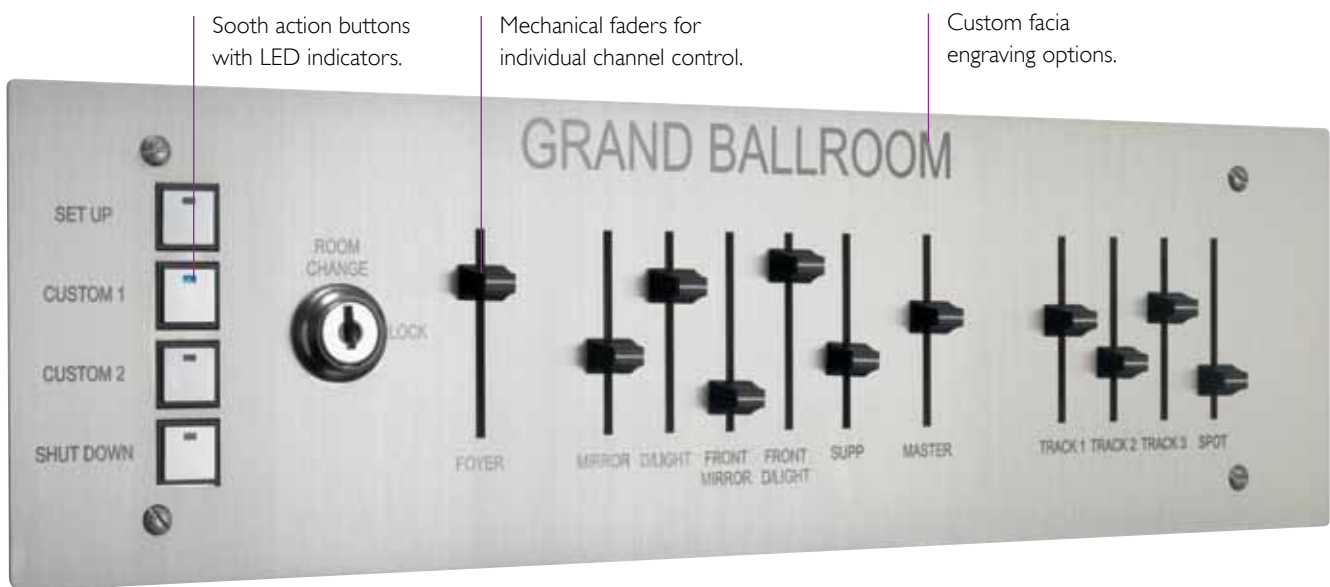

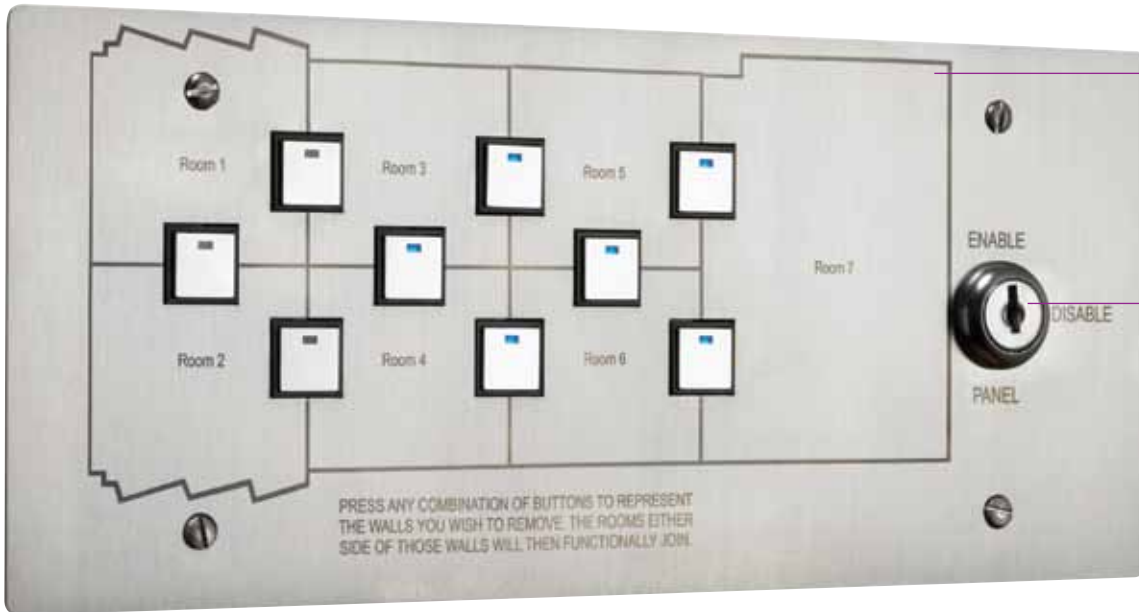

Robust custom
facia engraving
to the design of
your choice.

Keyswitches
lock out
unauthorised
use.

Custom features

Led indicators

Available in a range of colours enabling clear indication of system status.

Optional devices

Vast range of optional devices including faders, displays, key switches and plug sockets for unique control solutions.

Facia options

Suitable for an extensive range of materials providing unlimited décor matching possibilities.

Button and facia engraving

Clearly designates buttons functions ensuring intuitive system operation.



Custom engraving allows you to identify the function of each button, using symbols or text.

Buttons are easily removed and replaced if your requirements change.

Vast range of optional devices gives ultimate control.



Touchscreens

A Philips Dynalite touchscreen adds to any system a new dimension of control opportunities. Each touchscreen supports a range of features that can be used together giving end-users the ultimate in interaction with the automation system. The intuitive screen interface can be custom created to control the various elements within any automation, from one location.



Facia shown in brushed stainless steel finish.

Intuitive touchscreen functionality.

2 screen sizes
 DTPI00: 146mm x 88mm
 DTPI70: 233mm x 149mm.

Easily integrates with third-party systems.

DTP170-SS

DTP100-BG



Facia shown in black glass finish.

Incorporates clip-on fascia capability, so other architectural surfaces can be used.

Control any automation from one location.

Screen interface can be custom created.

Different touchscreen sizes are available to suit the required function.



Facia shown in white glass finish.

Colour of facia can also be matched with revolution or custom control panels.

Intuitive floor plans can be displayed for easy user navigation.

Larger touchscreens feature infra-red receive functionality.

DTP170-WG



DynamicTouch apps

The DynamicTouch app is ideal for 'intelligent homes' and commercial control applications. DynamicTouch combines easy-to-use operability with advanced functions, permitting Philips Dynalite control system elements to be accessed and configured via an iPad or iPhone device.

DynamicTouch

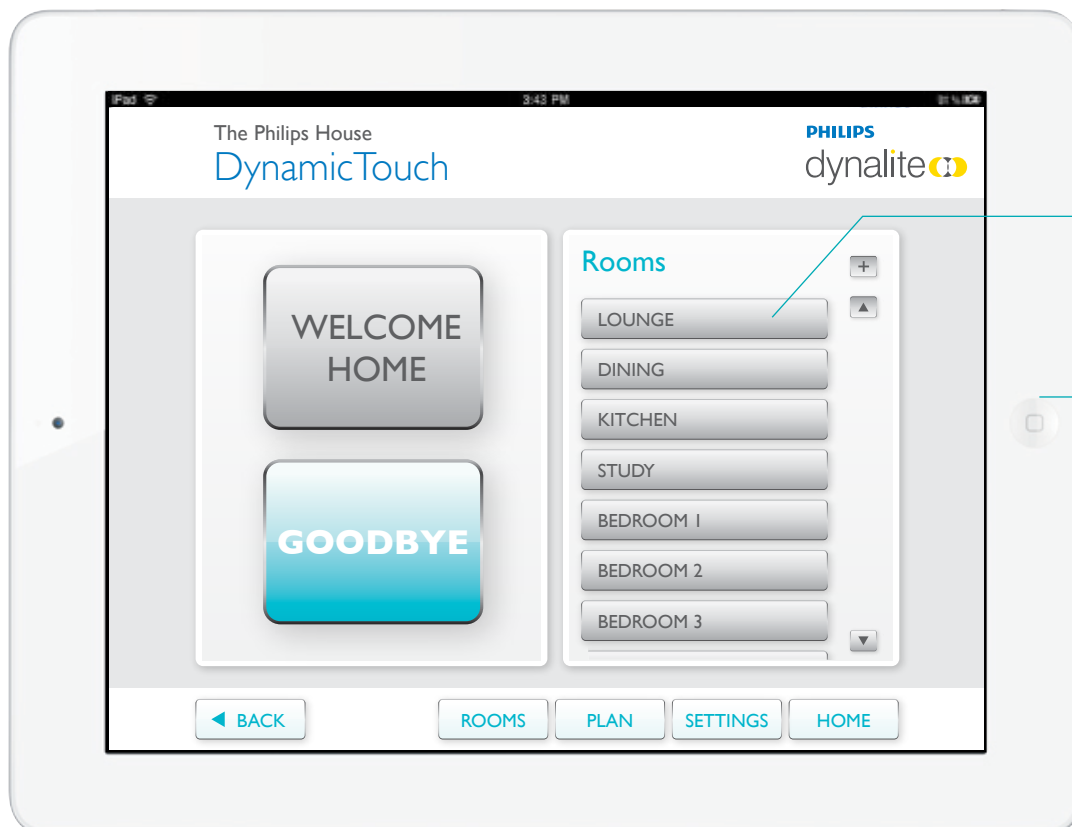

Individual lighting levels can easily be adjusted then saved to a button to be recalled at a later date.

Buttons can be custom labelled to allow for ease-of-use.

The iPad can be placed in wall-mounted cradle and used as a touchscreen operator interface.

Other elements within the space such as blinds and airconditioning may also be added to the scope of control available.

Reduces the total cost of deploying automation and control systems, putting them within reach of a wider range of businesses and homeowners.



Easy-to-use application will allow iPad and iPhone owners to configure lighting schemes, adjust preset levels and run task-specific customised macros, both remotely and on-site.

Third-party control systems, such as AV, blind and temperature control can also be accessed.

Users will be able to ring changes to third-party systems that are interfaced with the lighting control system network.

DynamicTouch helps consolidate control system functionality – one application to manage all automated processes.



Individual lighting levels can easily be adjusted then saved to a button to be recalled at a later date.

Each button can be custom labelled for ease-of-use.

Connect to the Philips Dynalite Ethernet gateway in the control system.

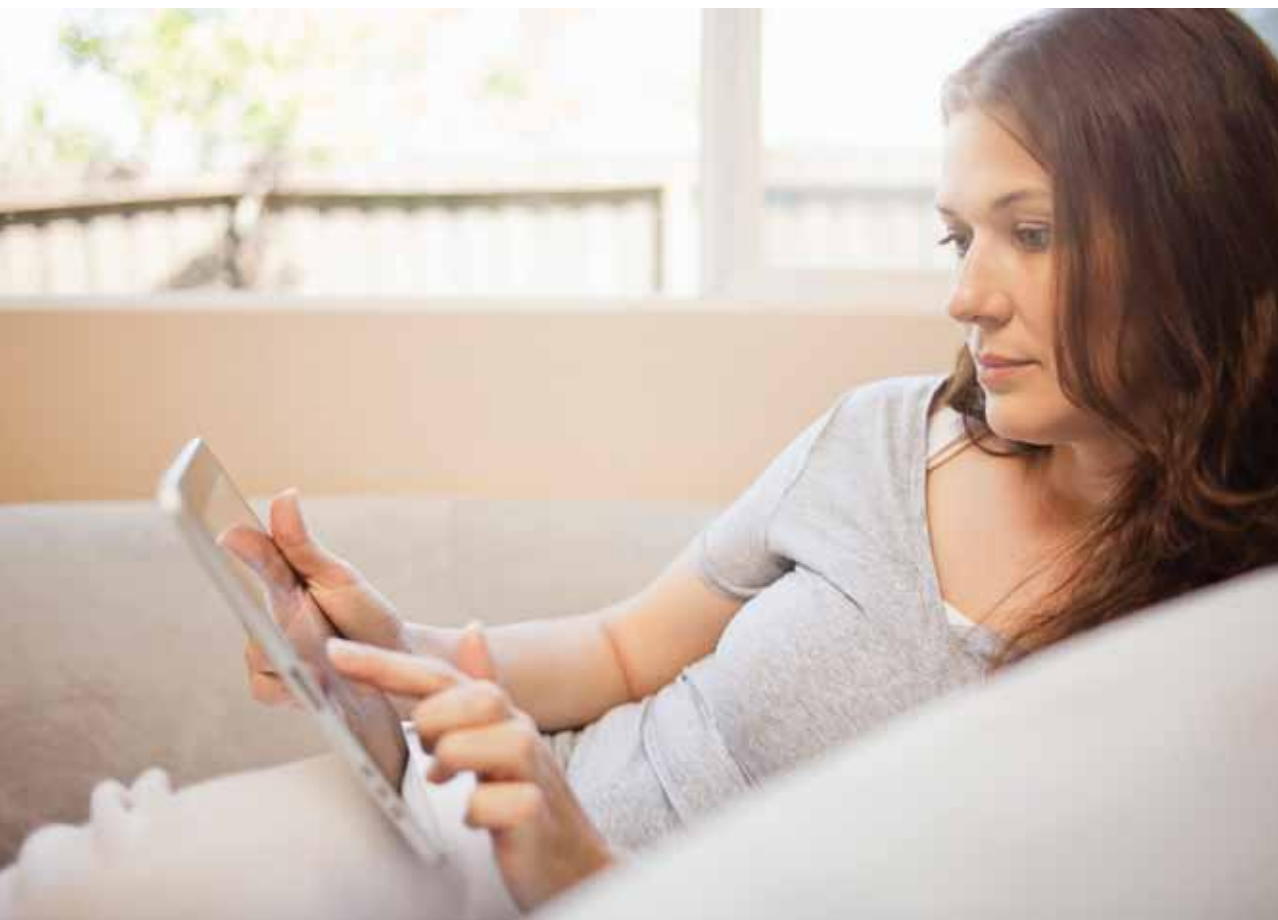

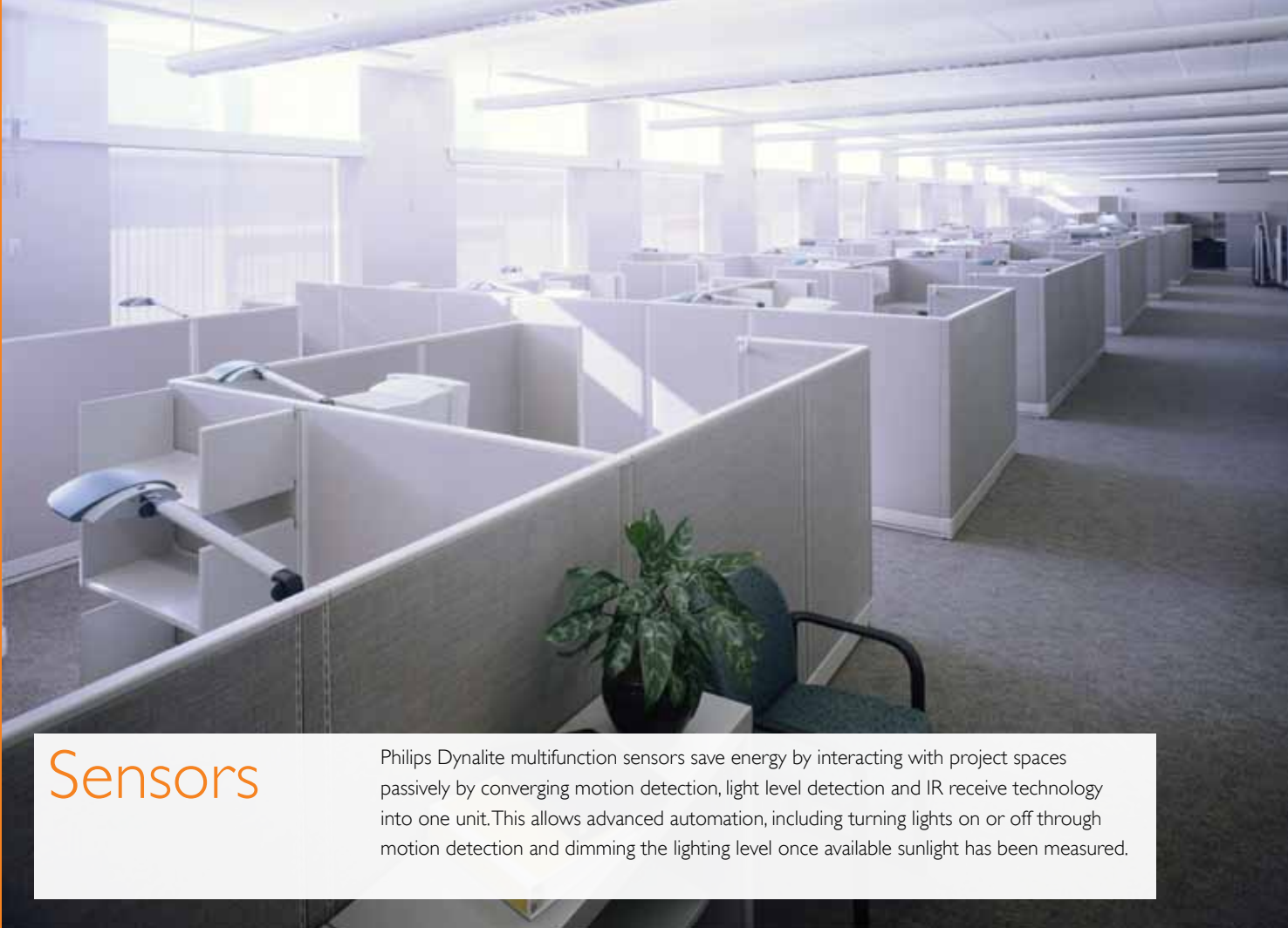

Sensors

Philips Dynalite multifunction sensors save energy by interacting with project spaces passively by converging motion detection, light level detection and IR receive technology into one unit. This allows advanced automation, including turning lights on or off through motion detection and dimming the lighting level once available sunlight has been measured.

All Multifunction Sensors feature:

- Motion detection, light level detection and IR receive in one unit.
- Detects motion to switch on the lights.
- Automatic 'Daylight Harvesting' mode.
- Unoccupied room lighting can be dimmed or turned off.
- Inbuilt microprocessor in each sensor:
- Logical functions control a small room, the floor of a building or an entire building.
- All sensors receive their power from the DyNet network.
- Fully and remotely programmable.
- Can be configured to automate and control unlimited controlled outputs.

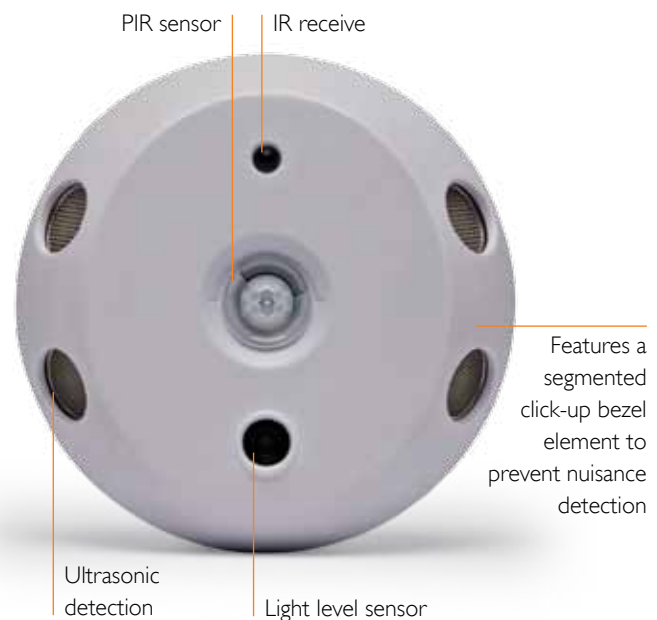

DUS804C-UP Multifunction Sensor

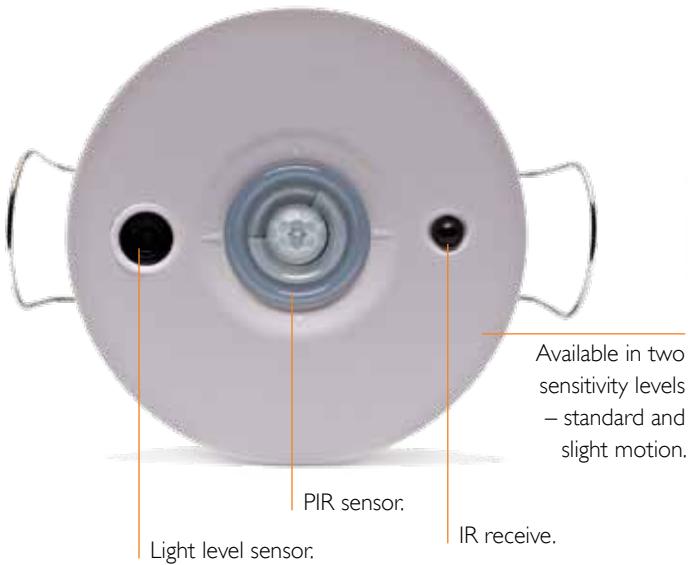

DUS804C Multifunction Sensor



DUS704C Multifunction Sensor

Benefits include improved operational efficiency and less need for many different types of sensors cluttering ceiling space.



DUS704W Universal Sensor

IR receive • PIR sensor
• Light level sensor.

Temperature Sensors



Temperature Sensor DTS900M



Temperature Sensor DTS900

Ordering information

Technical information and product ordering codes for user interfaces and options are outlined in this section. Please contact your local Philips Dynalite Representative or Distributor for more information and advice.

Revolution Series

Panel ordering information

Button colour	Cover Finish
White	Brushed Stainless Steel
Charcoal	Black Borosilicate Glass
Silver	White Optically Clear Starfire Glass
	Polished Brass (Gold Plated Polished Stainless)
	Antique Bronze
	White (Powder Coated Stainless)
	Mirrored Stainless
	No Cover

Dimensions

DR2PA

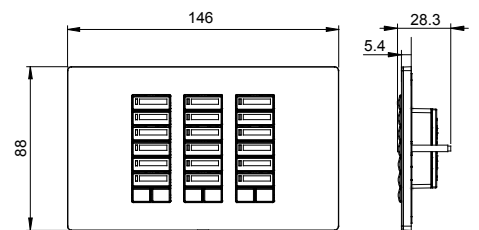
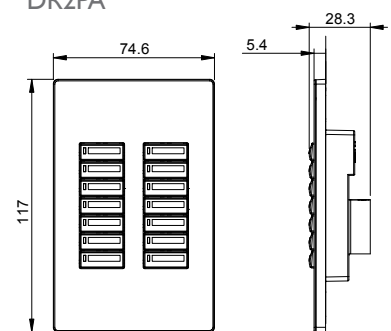

DR2PE

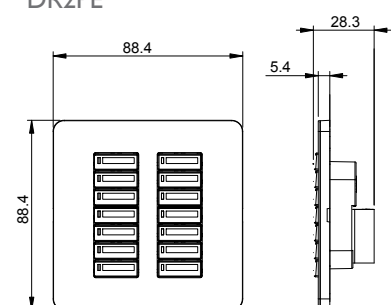

Button configurations

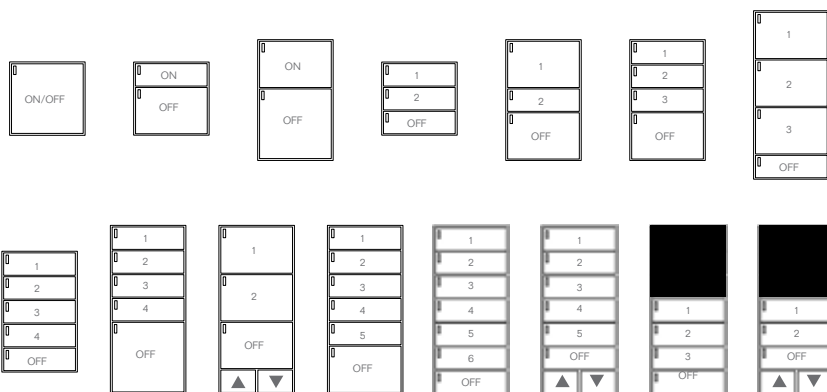

Classic Series

Panel ordering information

Part number = DPN, DPNE, DPN-SF or DPNE-SF plus number below:				PLUS finish code:	
926	2 Button 2 Room Join Panel	951F4	5 Button Preset 4 Fader Panel	MS	Mirrored Stainless Steel
908J	0 Button Panel with 2 Room Join Keyswitch	951F6	5 Button Preset 6 Fader Panel	GS	Gold Plated Stainless Steel
908J3	0 Button Panel with 3 Room Join Keyswitch	951F8	5 Button Preset 8 Fader Panel	BS	Coated Solid Brass
941FI	4 Button Preset Panel with Single Fader	951F12	5 Button Preset 12 Fader Panel	PC	Custom Powdercoat*
941D	4 Button Preset Panel with Panel Enable Keyswitch	981D	8 Button Preset with Panel Enable Keyswitch		
941N	4 Button Preset Panel with DyNet Socket	981J	8 Button Preset Panel with 2 Room Join Keyswitch		
941J	4 Button Preset Panel with 2 Room Join Keyswitch	981J3	8 Button Preset Panel with 3 Room Join Keyswitch		
941J3	4 Button Preset Panel with 3 Room Join Keyswitch	981N	8 Button Preset Panel with DyNet Socket		
946	4 Button 3 Room Join Panel	982J	8 Button Program Panel with 2 Room Join Keyswitch		
946D	4 Button 3 Room Join Panel with Disable Keyswitch	982J3	8 Button Program Panel with 3 Room Join Keyswitch		

*Consult your Philips Dynalite Dealer for advice.

Dimensions

DPN

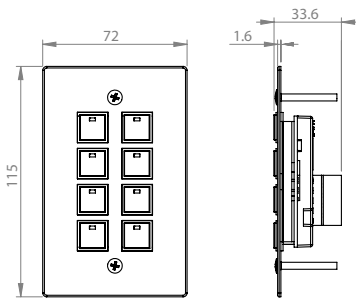

DPNE

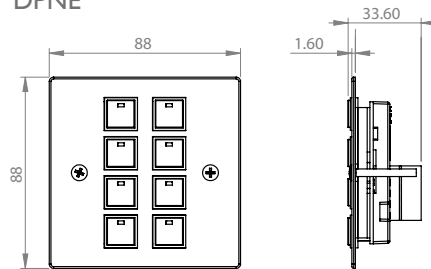

DPN-SF

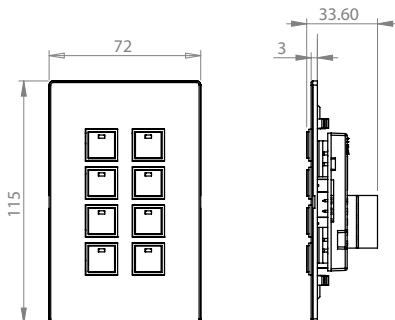

DPNE-SF

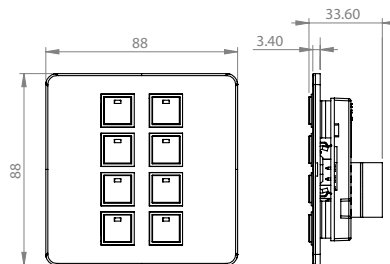

Ordering information cont.

Standard Series

Panel ordering information

Detailed below are catalogue numbers for the standard panel configurations, which are supplied complete with blue LED status indicators,

DLP	white covers, blank white buttons and white bezels
DLPE	brushed stainless steel covers, charcoal grey buttons and charcoal grey bezels
DL2P	white covers, blank white buttons and white bezels
DPWE	white covers, blank white buttons and white bezels

Grid Plate	Configurable Panel			
	DLP	DLPE	DL2P	DPWE
1 Button	DLP910	DLPE910	DL2P910	DPWE950
2 Button	DLP920	DLPE920	DL2P920	
5 Button	DLP950	DLPE950	DL2P950	
6 Button	DLP960	DLPE960	DL2P960	DPWE9100
7 Button	DLP970	DLPE970	DL2P970	
10 Button	DLP9100	DLPE9100	DL2P9100	

Dimensions

DLP

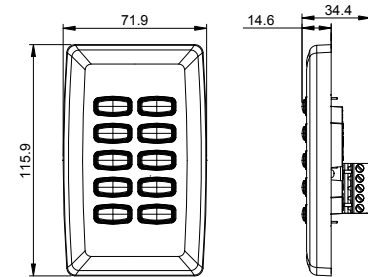

DL2P

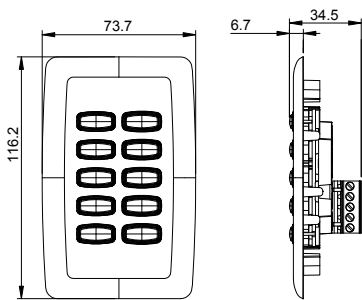

DLPE

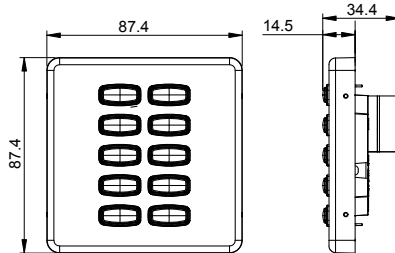

DPWE

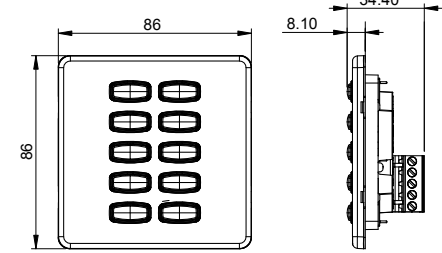

Touchscreen

Panel ordering information

DTP100*

DTP100	Stainless Steel (standard)
DTP100-BG	Black Glass fascia (option)
DTP100-WG	White Glass fascia (option)

*Custom fascia finishes also available
– ask your Philips Dynalite representative.

DTP100

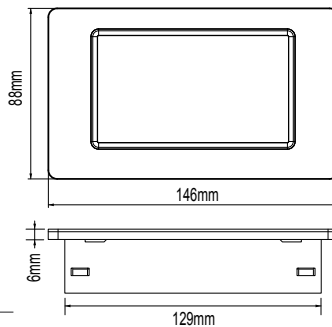

DTP170

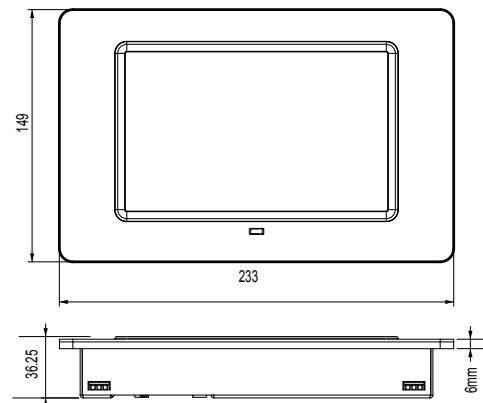

DTP170**

DTP170	Stainless Steel fascia, no wallbox
DTP170-WB	Stainless Steel fascia, with wallbox
DTP170-WALLBOX	Wallbox only

**Custom fascia finishes also available

DynamicTouch apps

Go to: <http://itunes.apple.com/app/dynamictouch/id446998947?mt=8>

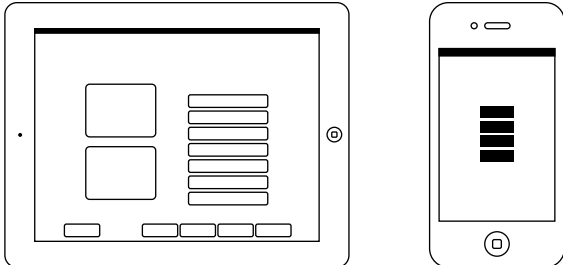

Sensors

Panel ordering information

DUS804C-UP		
DUS804C		SM – Slight motion sensitivity
DUS704C	102mm diameter x D 30mm	
DUS704W	H 85mm x W 66mm x D 45mm	LR – Long range
DTS900		
DTS900M		

DUS804C-UP

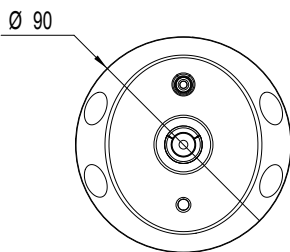

DUS804C

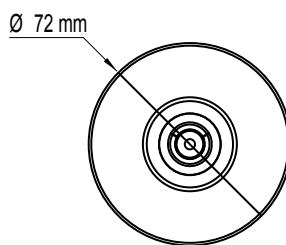

DUS704C

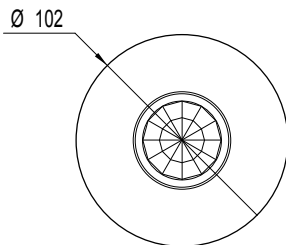

DTS900 & DTS900M

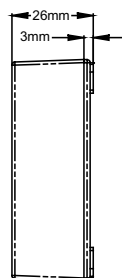
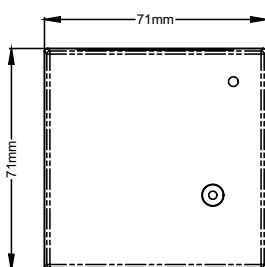

DUS704C
– lens pattern

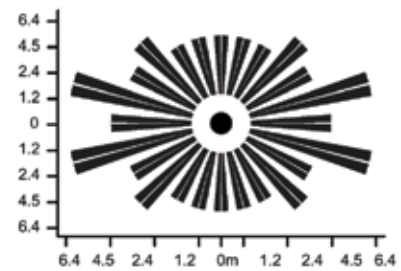

DUS704W
– long range lens pattern

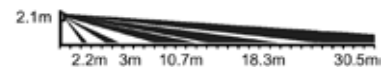

DUS804C
– long range lens pattern

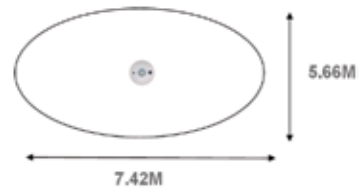

DUS804C-SM
– long range lens pattern

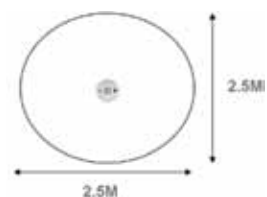

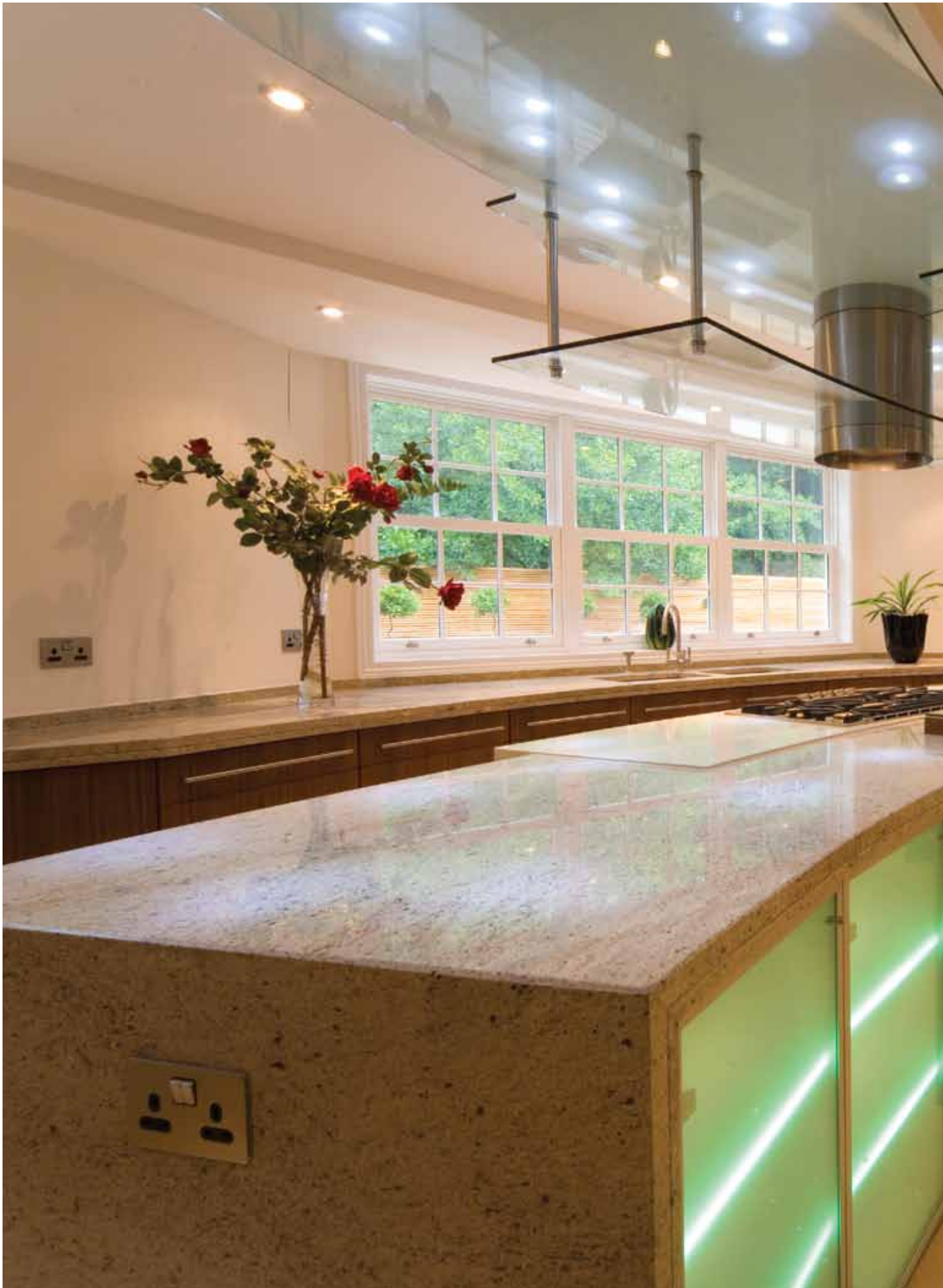

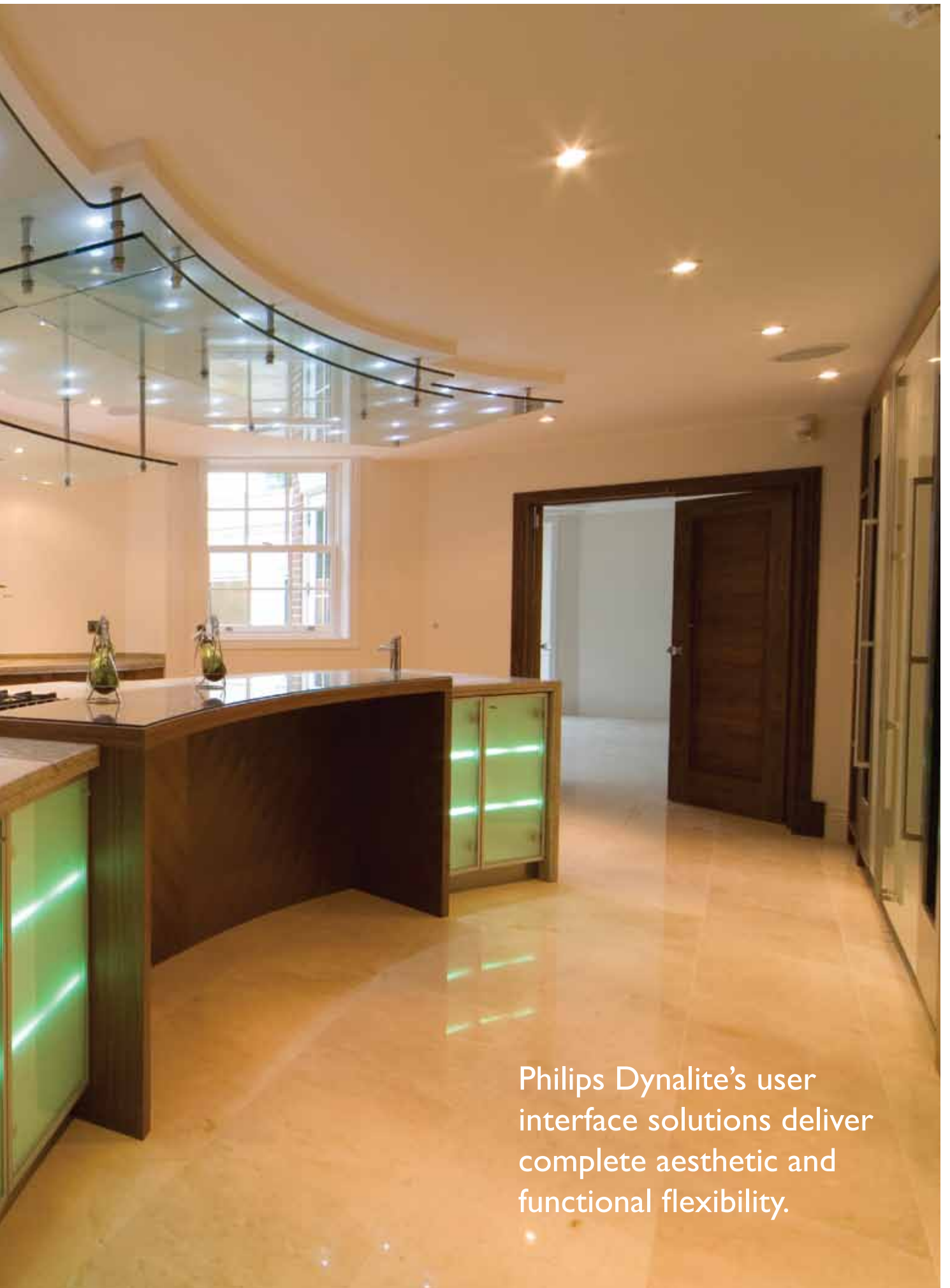

Philips Dynalite's user interface solutions deliver complete aesthetic and functional flexibility.

Headquarters & All other countries/regions

P: +61 (0) 2 8338 9899
E: dynalite.info@philips.com

Australia, New Zealand

SYDNEY, AUSTRALIA
P: +61 (0) 2 8338 9899
E: dynalite.info@philips.com

North Asia

SHANGHAI, PR CHINA
P: +86 21 2412 8035
E: china.dynalite@philips.com

South Asia

SINGAPORE, SINGAPORE
P: +65 9170 1974
E: asia.dynalite@philips.com

India

DELHI, INDIA
P: +91 124 460 6333
E: dynalite.info@philips.com

Europe (ex.UK)

EINDHOVEN, THE NETHERLANDS
E: info.lightingcontrols@philips.com

United Kingdom

GUILDFORD, UNITED KINGDOM
P: +44 (0) 148 329 8950
E: lcuk.sales@philips.com

Middle East & Turkey

DUBAI, UAE
P: +971 4 446 1100
E: met.controls@philips.com

Kingdom of Saudi Arabia

RIYADH, KINGDOM OF SAUDI ARABIA
P: +966 1 462 8060
E: ksa.controls@philips.com

Africa

CAIRO, EGYPT
P: +20 2 2480 1450
E: africa.controls@philips.com

United States

DALLAS, TEXAS
P: +1 800 526 2731
E: controls.support@philips.com
W: lightolier.com

Canada

LACHINE, QUEBEC
P: +1 514 636 0670
E: controls.support@philips.com
W: canlyte.com

South America

SAO PÁULO, BRAZIL
P: +55 11 2121 0203
E: luz.spot@philips.com

www.philips.com/dynalite

For more information, please contact

