

The DTC602 is an astronomical 365 day timer clock with Sunrise/Sunset tracking, automatic Daylight Saving adjustment and powerful macro and conditional logic functions. The timer clock interfaces with other devices over the DyNet RS485 network to automate tasks and events. It may be used as an energy management controller or simply to select scenes at preset times of the day or week. The DTC602 is powerful enough to provide full automation of a large commercial project and can be programmed with events that automatically run at the specified time. A typical application entails automating lighting levels in a restaurant for breakfast, lunch, dinner, evening entertainment and cleaning. A manual button press can over-ride the pre-programmed events until the next timed event occurs.

In energy management applications, the timer clock sets the operating mode of other devices, such as Philips Dynalite DUS704 sensors, to give priority to either IR, PIR or PE facilities, depending on the time of day or day of week. The DTC602 can be programmed and operated remotely via a PC or via the front panel LCD display and keypad, which incorporates a PIN password to prevent unauthorised adjustment. The DTC602 can be used to make programming changes to a Philips Dynalite system without the use of a computer. The LCD display will help guide the user step by step through the programming task. Information such as channel, area and preset scene names are automatically uploaded from the network to assist in programming. It can be used in conjunction with standard control panels to access preset scenes that are not commonly used or that require protection from accidental selection. The device is available in Aus/US (DTC) & UK/Euro (DTCE) mounting configurations.

technical data 



DTC602



DTCE602

Supply

12V DC at 50mA from the DyNet network

Control IO

1 x RS485 DyNet serial port

User Controls

1 x 122 x 32 pixel rear lit LCD display
 1 x 12 button LCD transport keys
 1 x 12 button numeric keypad

Clock

365 day clock
 Battery back up
 Sunrise/Sunset tracking
 Automatic daylight saving adjustment
 250 timed events
 64 tasks

Memory

All data stored in 100 year life EEPROM

Compliance

CE, C-Tick

Operating Environment

0° to 50°C ambient temperature
 0% to 95% RH non condensing

Construction

1.6mm stainless steel faceplate/body

Dimensions

DTC602:
 H 115mm x W 164mm x D 24mm

DTCE602:

H 86mm x W 146mm x D 24mm

Weight

Packed weight 0.2kg

mounting dimensions DTC602 >>>

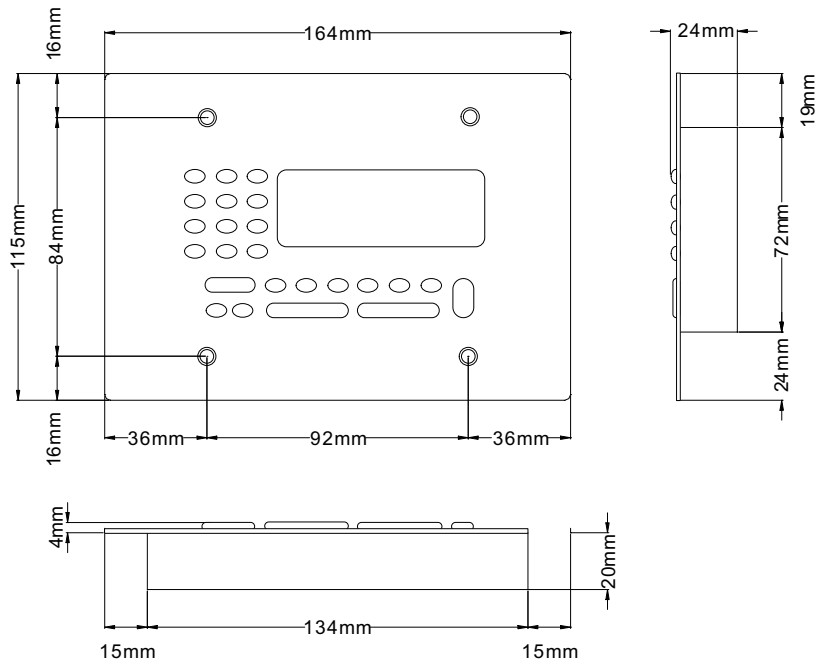

mounting dimensions DTCE602 >>>

